

MINN PROJ NO STBG 4725 (241)

STATE PROJECT NO. S.P. 047-603-013

PAVEMENT RECLAMATION, BITUMINOUS SURFACE AND AGGREGATE SHOULDERS

LOCATED ON: CSAH 3 BETWEEN: WEST COUNTY LINE AND TH 22

LOCATED IN: T.121N. R.31W. SECTIONS: 30-34 AND: T.121N. R.32W. SECTIONS: 25-36

GRADED UNDER S.P.047-511-07 (1955), S.P.047-511-04 (1954) AND S.P.047-511-01 (1951)

GROSS LENGTH	56,444	FEET	10.690	MILES
BRIDGES—LENGTH		FEET		MILES
EXCEPTIONS—LENGTH	50	FEET	0.009	MILES
NET. LENGTH	56,394	FEET	10.681	MILES

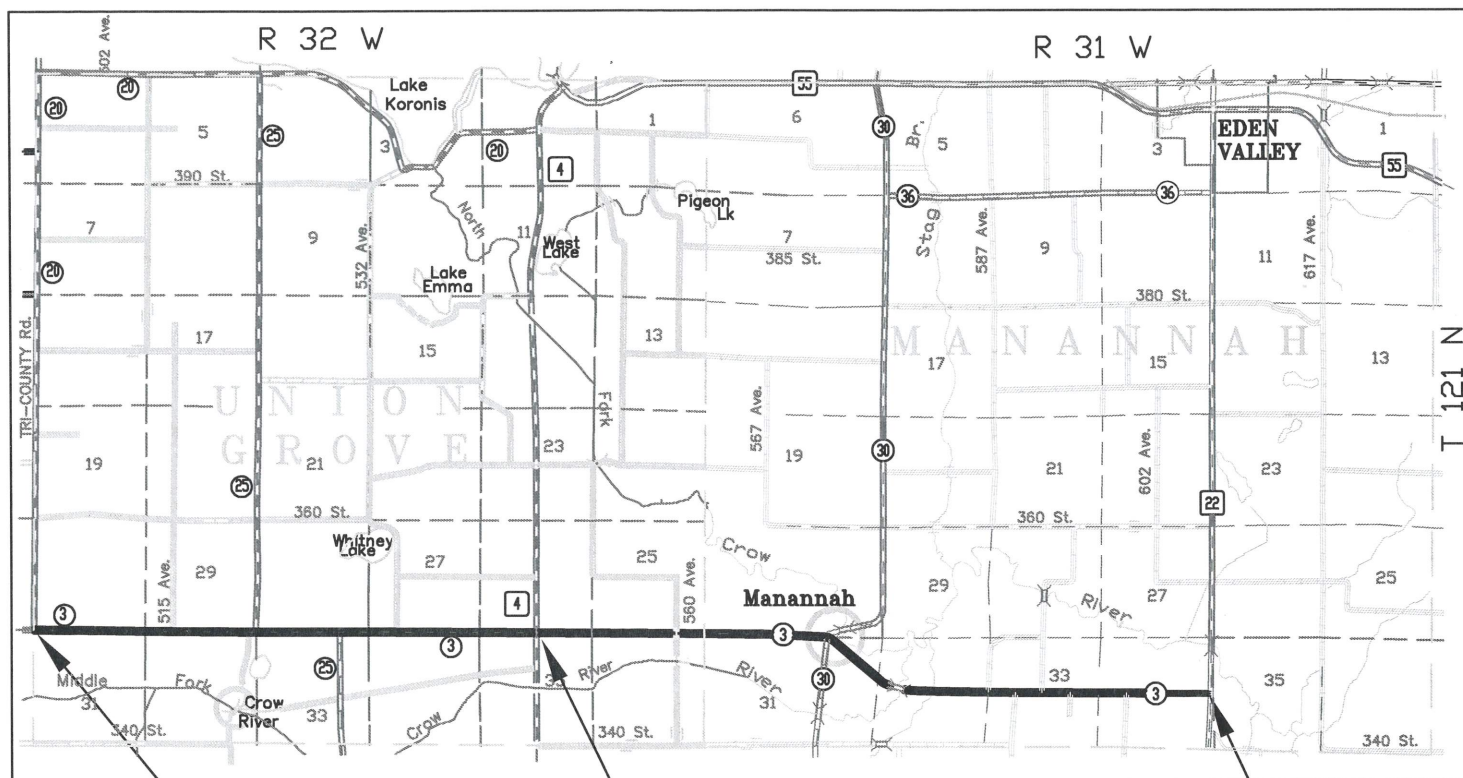

0 1
SCALE: MILES

BEGIN
SP 047-603-013
STA 0+00
REF. PT. 0+00.000

EXCEPTION
SP 047-603-013
STA. 236+50 -
STA. 237+00

END
SP 047-603-013
STA. 564+44
REF. PT. 10+00.690

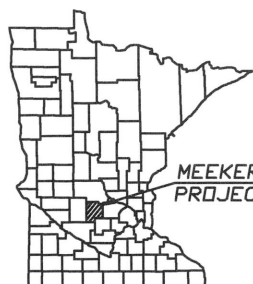

Outline Map of Minnesota
showing location of county
within the State.

DESIGN DESIGNATION

POSTED SPEED 55 MPH
ADT (2025) = 350
PROJ. ADT (2045) = 390
R VALUE = 18
Design BESALS = 116,000
10 TON DESIGN
SHOULDER WIDTH 1'-3'VAR.

INDEX

SHEET 1 – TITLE SHEET
SHEET 2 – ESTIMATED QUANTITIES
SHEET 3-6 – TYPICAL SECTIONS
THIS PLAN CONTAINS 6 SHEETS

GOVERNING SPECIFICATIONS
THE 2020 EDITION OF THE MINNESOTA DEPARTMENT OF
TRANSPORTATION "STANDARD SPECIFICATIONS FOR
CONSTRUCTION" SHALL GOVERN.

SIGNATURE

I HEREBY CERTIFY THAT THIS PLAN WAS PREPARED BY ME OR UNDER MY DIRECT SUPERVISION, AND THAT I AM A DULY LICENSED PROFESSIONAL ENGINEER UNDER THE LAWS OF THE STATE OF MINNESOTA.

DATE 01/17/2025 PRINTED NAME PHIL SCHMALZ LICENSE NUMBER 50403

APPROVED: [Signature]
MEEKER COUNTY ENGINEER

DATE: 1/17/2025

DISTRICT STATE AID ENGINEER: REVIEWED FOR
COMPLIANCE WITH STATE AND/OR FEDERAL AID RULES/POLICY

DATE:

DATE: _____
APPROVED FOR STATE AND/OR FEDERAL AID FUNDING: STATE AID ENGINEER _____

STATE PROJECT No. 047-603-013			
CSAH 3 FULL DEPTH RECLAMATION AND PAVING			
ESTIMATED QUANTITIES			
SPEC. NO.	ITEM	UNIT	EST. QUANTITY
2021.501	MOBILIZATION	LS	1
1) 2112.602	SUBGRADE PREP	EACH	18
2) 2215.504	FULL DEPTH RECLAMATION	SY	167,868
3) 2221.509	SHOULDER BASE AGGREGATE, CL 1 (P)	TON	5,606
4) 2232.504	MILL BITUMINOUS SURFACE (VAR DEPTH)	SY	190
5) 2357.506	BITUMINOUS MATERIAL FOR TACK COAT	GAL	10,116
6) 2360.509	TYPE SP 12.5 NON WEARING COURSE MIXTURE (2, C)	TON	23,710
7) 2360.509	TYPE SP 9.5 WEARING COURSE MIXTURE (2, C)	TON	14,287
8) 2540.602	MAILBOX SUPPORT	EACH	19
9) 2582.503	4" BROKEN LINE PAINT	LIN FT	1,076
10) 2582.503	4" SOLID LINE PAINT	LIN FT	19,202
11) 2582.503	6" SOLID LINE PAINT	LIN FT	111,502

(P) DESIGNATES PLAN QUANTITY

NOTES:

- 1) INCLUDED FOR SHAPING 14 GRAVEL DRIVEWAY APRONS, 2 ROAD APPROACH APRONS AND 1 PARKING LOT APRON PRIOR TO PAVING. ALSO INCLUDES SALVAGE AND REPLACE EXISTING GRANITE AT ONE DRIVEWAY ENTRANCE.
- 2) INCLUDES 4,808 SY FOR APPROACHES AND ENTRANCES.
- 3) INCLUDES 972 TONS FOR APPROACHES AND ENTRANCES.
- 4) SEE TAB **(A)** FOR LOCATIONS.
- 5) INCLUDES 335 GALLONS FOR ROAD APPROACHES, ENTRANCES AND SHOULDER PAVING AT STA.381+60 TO STA.387+00.
- 6) INCLUDES 678 TONS FOR ENTRANCES AND APPROACHES.
- 7) INCLUDES 467 TONS FOR ENTRANCES, ROAD APPROACHES AND SHOULDER PAVING AT STA.381+60 TO STA.387+00.
- 8) INCLUDES REMOVING INPLACE POST, INSTALLING NEW POST AND SALVAGING INPLACE MAILBOX AND REPLACING ON POST. IF MAILBOX CANNOT BE SALVAGED A NEW BOX WILL BE PROVIDED BY THE COUNTY. REPLACEMENT POST LOCATIONS WILL BE DESIGNATED ON THE PROJECT.
- 9) ON THE FINAL WEAR COURSE ONLY, PAINT SHALL BE YELLOW.
- 10) ON THE FINAL WEAR COURSE ONLY, PAINT SHALL BE YELLOW. INCLUDES 5,852 LIN FT OF DOUBLE SOLID PAINT (2,926 ACTUAL ROAD LIN FT).
- 11) ON THE FINAL WEAR COURSE ONLY, PAINT SHALL BE WHITE.

(A) MILL BITUMINOUS SURFACE (VAR.)			
LOCATION	LENGTH (FT)	WIDTH (FT)	AREA (SY)
CSAH 3 STA. 0+00	22	6	15
520TH AVE.	24	4	11
CSAH 25 NORTH	24	4	11
CSAH 25 SOUTH	28	4	12
DVWY 53800	95	2	21
TH 4 WEST	43	4	19
TH 4 EAST	25	4	11
DVWY 56744	13	2	3
CSAH 30	27	4	12
574TH AVE.	69	4	31
CEMETARY ENT.	31	2	7
DVWY 57983	14	2	3
DVWY 60339	11	2	2
DVWY 60664	14	2	3
CSAH 3 STA. 564+44	44	6	29
TOTAL			190

THE FOLLOWING STANDARD PLATES AS APPROVED BY THE FHWA SHALL APPLY ON THIS PROJECT

8000K	TEMPORARY CHANNELIZERS
9000E	APPROACHES AND ENTRANCES
9350C	MAILBOX SUPPORT

NOTES:

TRAFFIC CONTROL WILL BE INCIDENTAL AND IS THE CONTRACTOR'S RESPONSIBILITY. ALL TRAFFIC CONTROL DEVICES SHALL CONFORM TO THE LATEST MMUTCD, INCLUDING THE LATEST FIELD MANUAL FOR TEMPORARY TRAFFIC CONTROL ZONE LAYOUTS.

TRAFFIC CONTROL LAYOUT FOR EACH "OPERATION" OF RECLAMATION/PAVING/SHOULDERING AND STRIPING SHALL MEET THE REQUIREMENTS OF THE CURRENT EDITION OF THE MMUTCD, INCLUDING THE FIELD MANUAL FOR TEMPORARY TRAFFIC CONTROL ZONE LAYOUTS.

THE SUBSURFACE UTILITY INFORMATION IN THIS PLAN IS UTILITY QUALITY LEVEL D. THIS UTILITY QUALITY LEVEL WAS DETERMINED ACCORDING TO THE GUIDELINES OF CI/ASCE 38-22, ENTITLED "STANDARD GUIDELINES FOR INVESTIGATING AND DOCUMENTING EXISTING UTILITIES".

BASIS OF PLANNED QUANTITIES

BITUMINOUS MIX - 113 lbs/sq yd/in deep
TACK COAT - 0.06 gal/sq yd
AGGREGATE SHOULDERING - 1 TON = 0.55 CU YD
QUANTITIES INCLUDED FOR: 108 GVL. FIELD APPROACHES
38 GVL. ENTRANCES
6 PAVED ENTRANCES
10 GVL. ROAD APPROACHES
5 PAVED ROAD APPROACHES

ESTIMATED QUANTITIES

CSAH 3
FROM WEST COUNTY LINE TO TRUNK HIGHWAY 4
STA. 0+00 to 236+80

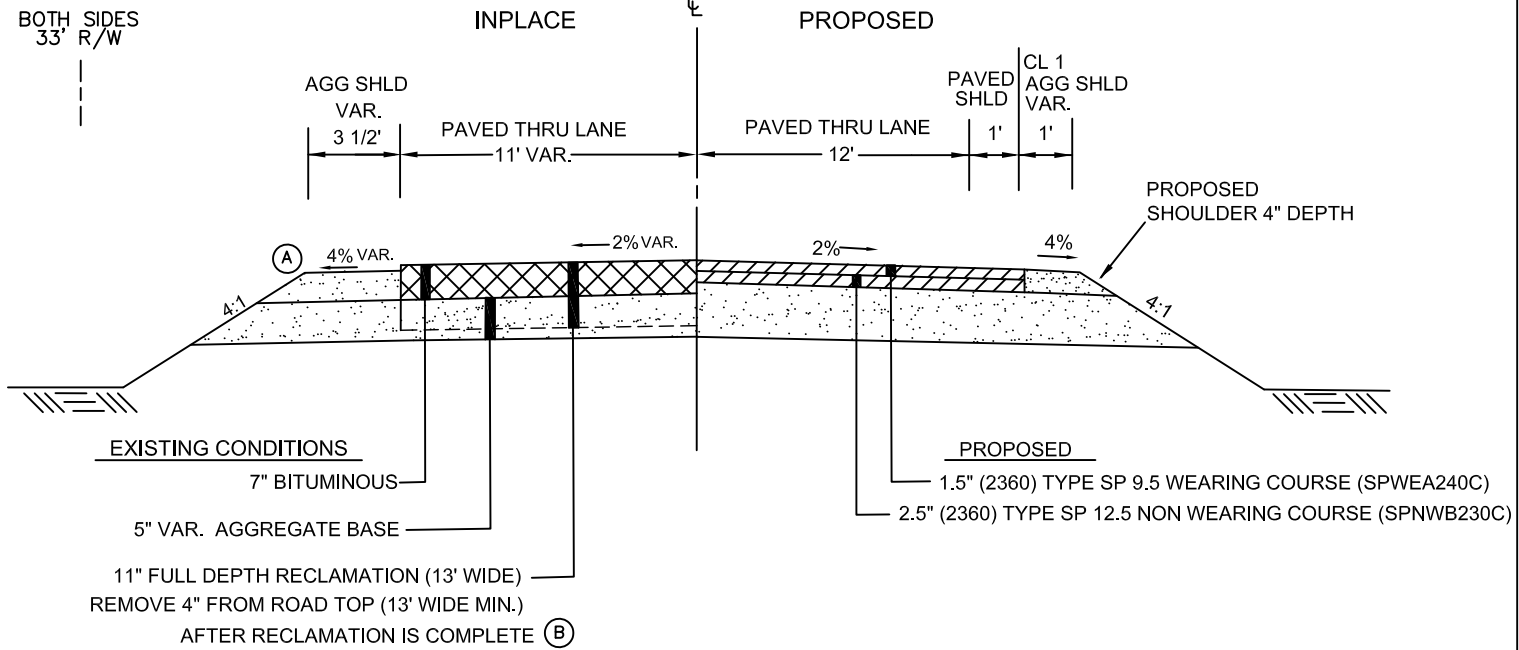

NOTES

- (A) EXISTING SHOULDER MATERIAL IS APPROXIMATELY 1.5" BELOW PAVEMENT EDGE. EXISTING SHOULDER MATERIAL SHALL BE PULLED IN AND BLENDED WITH RECLAIM MATERIAL AS NECESSARY, INCIDENTAL TO FULL DEPTH RECLAMATION.
- (B) REMOVING, HAULING AND STOCKPILING THE TOP 4" OF RECLAIMED MATERIAL IS INCIDENTAL TO FULL DEPTH RECLAMATION. RECLAIMED MATERIAL MAY BE USED IN LEIU OF CL1 AGG. ON PROPOSED SHOULDERS, DRIVEWAYS AND ENTRANCES, SUBJECT TO THE GRADATION REQUIREMENTS OF PASSING A 2 INCH SIEVE. THE REMAINING RECLAIMED MATERIAL SHALL BECOME THE PROPERTY OF THE CONTRACTOR.

ROAD HISTORY
CSAH 3 INPLACE FROM STA. 0+00 - STA. 236+80

(1955) S.A.P. 47-511-07 GRADED
(1959) S.A.P. 47-603-01 PAVED 1.5" BIT., 5" AGGREGATE
(1987) S.A.P. 47-603-08 OVERLAY 2" BIT.
(2017) S.A.P. 47-603-12 OVERLAY 1.5" BIT.

TYPICAL SECTION
DETAILS NOT TO SCALE

CSAH 3
FROM TRUNK HIGHWAY 4 TO CSAH 30
STA. 236+80 to 375+00

BOTH SIDES
33' R/W

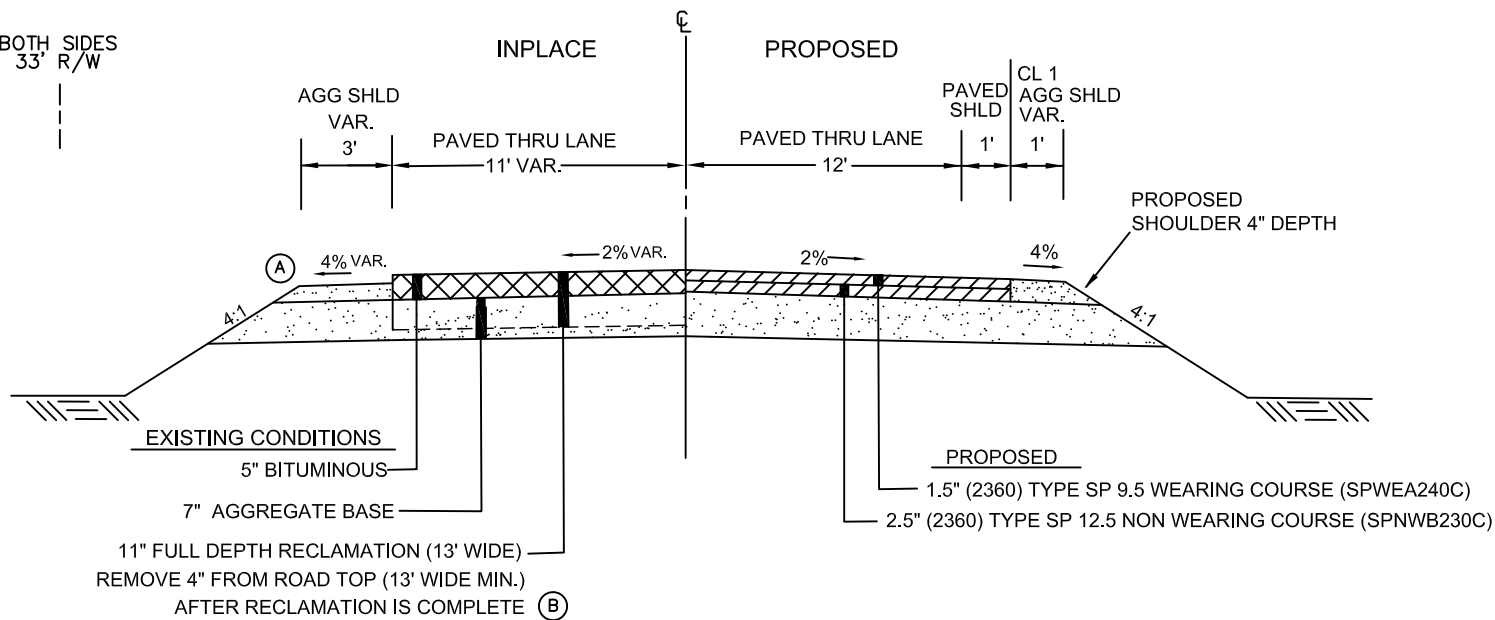

NOTES

- (A) EXISTING SHOULDER MATERIAL IS APPROXIMATELY 1.5" BELOW PAVEMENT EDGE.
EXISTING SHOULDER MATERIAL SHALL BE PULLED IN AND BLENDED WITH RECLAIM MATERIAL AS NECESSARY, INCIDENTAL TO FULL DEPTH RECLAMATION.
- (B) REMOVING, HAULING AND STOCKPILING THE TOP 4" OF RECLAIMED MATERIAL IS INCIDENTAL TO FULL DEPTH RECLAMATION. RECLAIMED MATERIAL MAY BE USED IN LEIU OF CL1 AGG. ON PROPOSED SHOULDERS, DRIVEWAYS AND ENTRANCES, SUBJECT TO THE GRADATION REQUIREMENTS OF PASSING A 2 INCH SIEVE.
THE REMAINING RECLAIMED MATERIAL SHALL BECOME THE PROPERTY OF THE CONTRACTOR.

ROAD HISTORY
CSAH 3 INPLACE FROM STA. 236+80 - STA. 375+00

(1954) S.A.P. 47-511-04 GRADED
(1958) S.A.P. 47-614-01 PAVED 1.5" BIT., 6" AGGREGATE
(1973) S.A.P. 47-603-06 OVERLAY 1.5" BIT.
(1987) S.A.P. 47-603-08 OVERLAY 2.5" BIT.

TYPICAL SECTION
DETAILS NOT TO SCALE

CSAH 3
FROM CSAH 30 TO 580' EAST
STA. 375+00 to 380+80

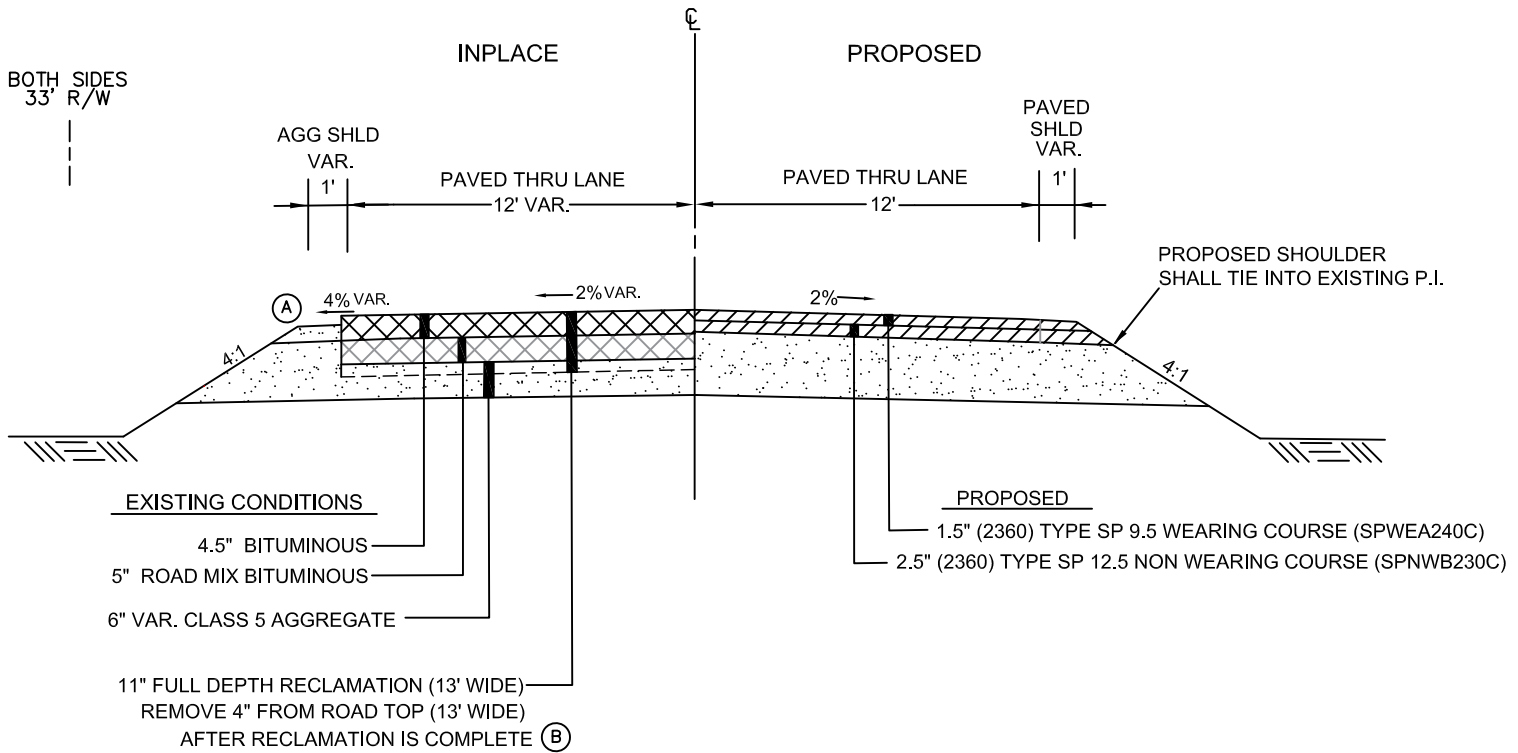

NOTES

- (A) EXISTING SHOULDER MATERIAL IS APPROXIMATELY 1.5" BELOW PAVEMENT EDGE. EXISTING SHOULDER MATERIAL SHALL BE PULLED IN AND BLENDED WITH RECLAIM MATERIAL AS NECESSARY, INCIDENTAL TO FULL DEPTH RECLAMATION.
- (B) REMOVING, HAULING AND STOCKPILING THE TOP 4" OF RECLAIMED MATERIAL IS INCIDENTAL TO FULL DEPTH RECLAMATION. RECLAIMED MATERIAL MAY BE USED IN LEIU OF CL1 AGG. ON PROPOSED SHOULDERS, DRIVEWAYS AND ENTRANCES, SUBJECT TO THE GRADATION REQUIREMENTS OF PASSING A 2 INCH SIEVE. THE REMAINING RECLAIMED MATERIAL SHALL BECOME THE PROPERTY OF THE CONTRACTOR.

ROAD HISTORY
CSAH 3 INPLACE FROM STA. 375+00 - STA. 564+44

(1951) S.A.P. 47-511-01 GRADED
(1955) S.A.P. 47-511-06 PAVED 1.5" ROAD MIX., 6" AGGREGATE
(1976) S.A.P. 47-603-07 OVERLAY 1.5" BIT.
(2001) NO PROJ. NO. OVERLAY 1.5" BIT.

TYPICAL SECTION
DETAILS NOT TO SCALE

CSAH 3
FROM 580' EAST OF CSAH 30 TO TRUNK HIGHWAY 22
STA. 380+80 to 564+44

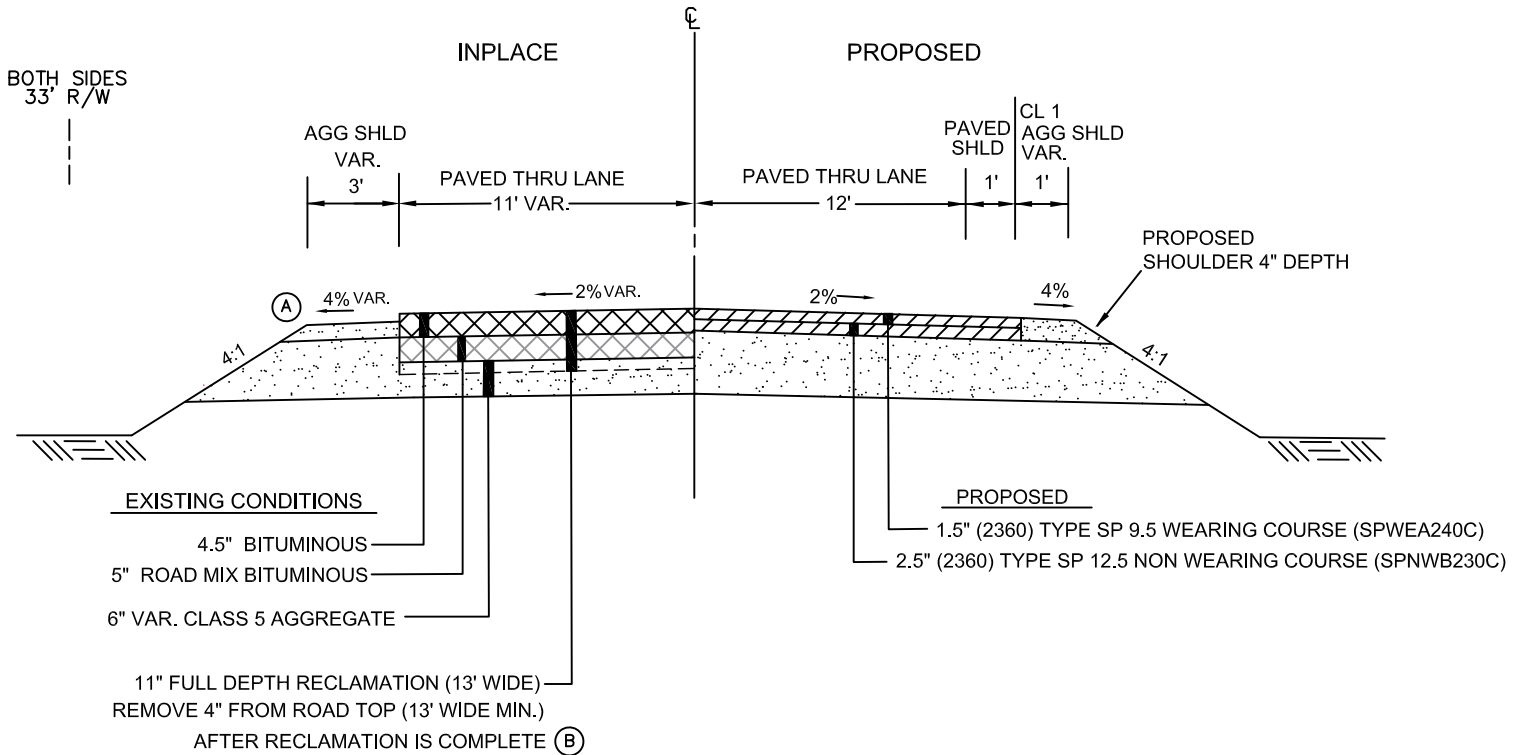

NOTES

- (A) FROM STA. 381+60 to 387+00 LT
INPLACE SHOULDER WIDTH IS 8'-18' (VAR.) PAVED
PROPOSED 1 1/2" OVERLAY ON EXISTING SHOULDER.

EXISTING SHOULDER MATERIAL IS APPROXIMATELY 1.5" BELOW PAVEMENT EDGE.
EXISTING SHOULDER MATERIAL SHALL BE PULLED IN AND BLENDED WITH RECLAIM MATERIAL AS NECESSARY,
INCIDENTAL TO FULL DEPTH RECLAMATION.
- (B) REMOVING, HAULING AND STOCKPILING THE TOP 4" OF RECLAIMED MATERIAL IS INCIDENTAL TO FULL DEPTH RECLAMATION.
RECLAIMED MATERIAL MAY BE USED IN LEIU OF CL1 AGG. ON PROPOSED SHOULDERS, DRIVEWAYS AND ENTRANCES,
SUBJECT TO THE GRADATION REQUIREMENTS OF PASSING A 2 INCH SIEVE.
THE REMAINING RECLAIMED MATERIAL SHALL BECOME THE PROPERTY OF THE CONTRACTOR.

ROAD HISTORY
CSAH 3 INPLACE FROM STA. 375+00 - STA. 564+44

(1951) S.A.P. 47-511-01 GRADED
(1955) S.A.P. 47-511-06 PAVED 1.5" ROAD MIX., 6" AGGREGATE
(1976) S.A.P. 47-603-07 OVERLAY 1.5" BIT.
(2001) NO PROJ. NO. OVERLAY 1.5" BIT.

TYPICAL SECTION
DETAILS NOT TO SCALE